

IPC-603

2U 3-Slot Rackmount Chassis for ATX/ MicroATX Motherboard with Front I/O



Features

- 308mm short depth front I/O 2U chassis
- Shockproof drive for slim ODD and one 3.5" HDD
- Equipped with 350W single power supply
- Easy-to-replace air filters

CE FCC

Specifications

		External	Internal
Drive Bay	Slim Optical Disk Drive	1	-
	3.5"	-	1
Cooling	Fan	2 (8 cm/47 CFM each)	
	Air Filters	3 (85 x 80 mm)	
Miscellaneous	Notification LEDs	Power & HDD activity	
Environment		Operating	Non-Operating
	Temperature	0 ~ 40 °C (32 ~ 104 °F)	-20 ~ 60 °C (-4 ~ 140 °F)
	Humidity	10 ~ 85% @ 40 °C, non-condensing	10 ~ 95% @ 40 °C, non-condensing
	Vibration (5 ~ 500 Hz)	1 Grms	2 G
Physical Characteristics	Dimensions (W x H x D)	482 x 88 x 308 mm (19" x 3.46" x 12.1")	
	Weight	6.4 kg (14.1 lb)	

Front View

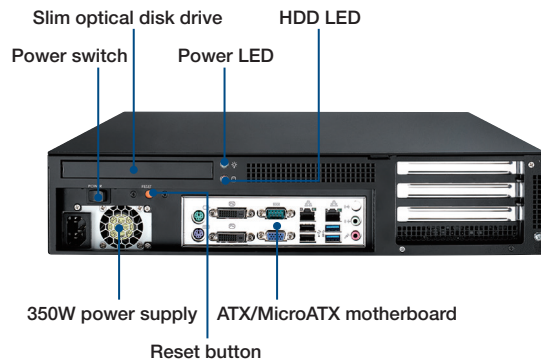

Inside View

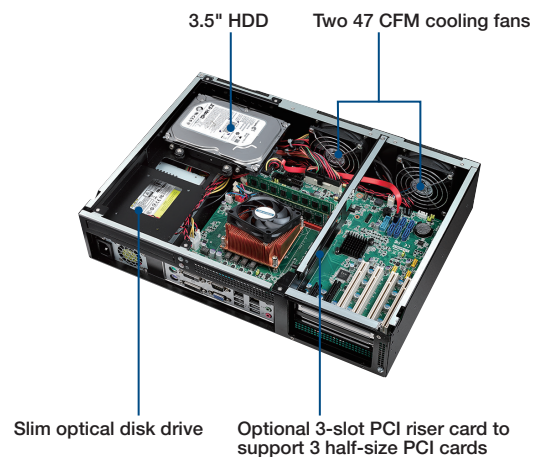

IPC-603

Dimensions

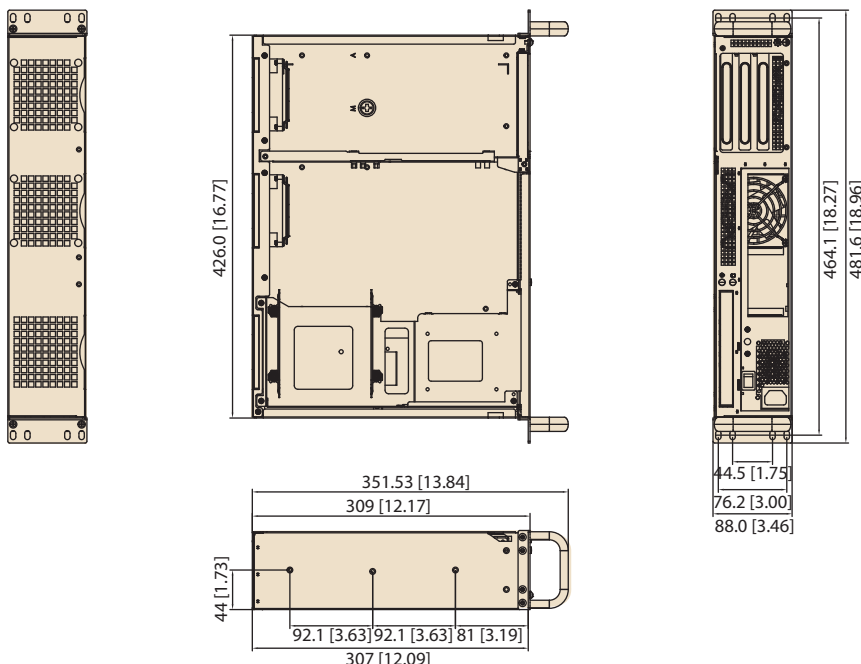

Ordering Information

Part Number	Power Supply	Wattage	Type	Input
IPC-603MB-35C	PS8-350FATX-GB	350W	Single	AC 100 ~ 240 V full range

Optional Accessories

Part Number	Description
96CB-SATAPOWER-6P2	SATA power wire 6-pin to big 4-pin (for slim ODD)

Spare Parts

Part Number	Description
2130004795S000	Fan filter 80 x 85 x 5 mm